

Runnymede Colliers Wood, SW19 2RG

£425,000 Leasehold



A beautifully presented and rear extended two double bedroom ground floor garden maisonette located close to Colliers Wood High Street / Tube Station, gyms and superb amenities. Spacious throughout with good sized lounge, dining area and modern kitchen with direct access to a delightful rear garden. This lovely property will not fail to impress and would make an Ideal first time purchase, or for any one looking for an amazing flat in the SW19 area with the added benefit of off street parking.

Runnymede, SW19

Approximate Gross Internal Area = 59.0 sq m / 636 sq ft

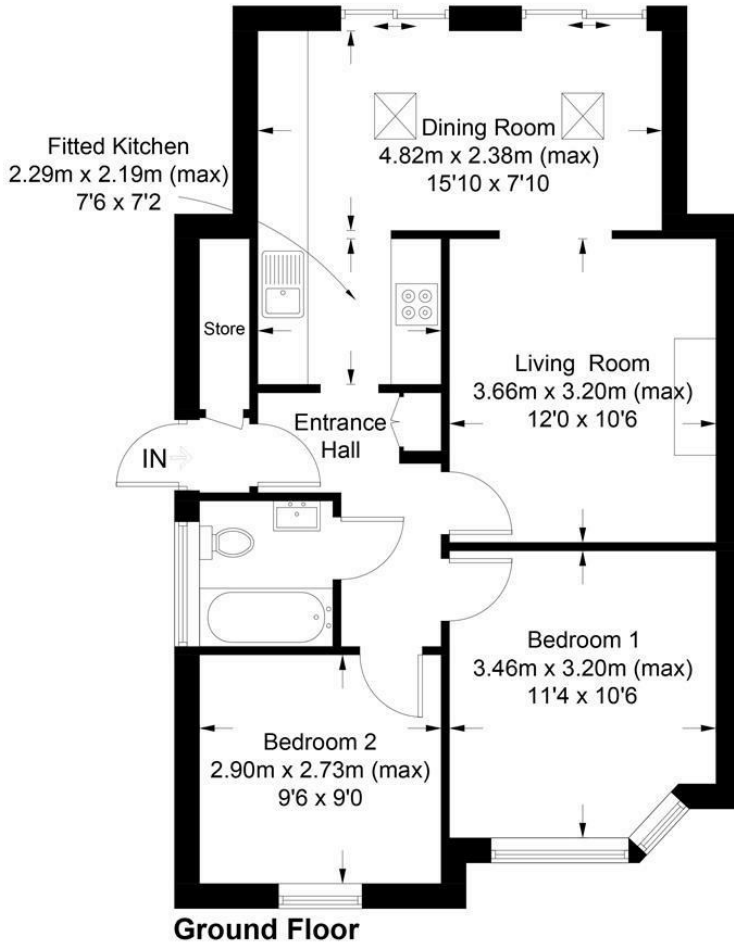

This floor plan is for representation purposes only and is not drawn to scale.
The Gross Internal Area includes outbuildings shown on the plan.
 Whilst every attempt has been made to ensure the accuracy of the plan measurements of doors, windows and rooms are approximate only and should be checked before making any decisions reliant upon them.
 Copyright Bespokeplans.co.uk (ID759647)

- Two Double Bedrooms
- Rear Extended
- Off Street Parking
- Private Garden
- Ideal First Time Purchase
- Sought After Location

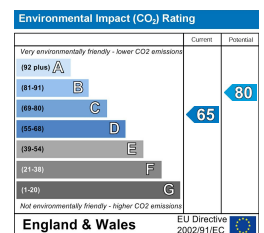
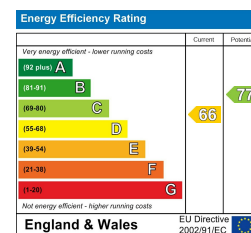

For Free Mortgage Quote and Best Mortgage Rates, call an Ellisons Mortgage Advisor on 020 8544 0518



Although these particulars are believed to be correct, their accuracy is not guaranteed and they do not form part of any contract.

Celebrating 30 years of successful Sales and Lettings in Merton

